

PowerSeal Family

“The PowerSeal’s unique, sealed design allows it to be used in tough environmental conditions.”



Trombetta



The power you need to switch high amperage applications along with its sealed construction give the PowerSeal its name. The PowerSeal’s unique design allows it to be used in tough environmental conditions – it passes IEC 60529, IP66 and IP67.

If your application requires a fully sealed design, you must have the PowerSeal. Specific applications that the PowerSeal powerfully supports include Hydraulic, RV, Grid Heater, and Lawn and Garden applications.



PowerSeal Specifications

Coil Terminals	1 (Grounded) or 2 (Ungrounded): 10-32 Studs
Contact Studs	5/16-24 Studs
Mounting Bracket	L, Flat, 90°, L Flat, L Curved, and Flat L Wide
Standard Operating Temperature Range	-40° C to 82° C

Coils						Contact				
Model	Max Sustained Duty Cycle ¹	Max On Time	Pull In Voltage ²	Hold Voltage ²	Coil Resist Ohms	Resistive Load Carry/Interrupt Capability (Amps) ³	Inductive Load Carry/Interrupt Capability (Amps) ³	Peak Inductive Inrush Capability (Amps) ⁴	Electrical Cycle Life	Contact Material
12V Intermit.	25%	6 min.	6	3.5	5.4	150/250	150/250	800	100,000	Copper
24V Intermit.	25%	6 min.	12	7.0	20.1	150/250	150/250	800	60,000	Copper

¹Nominal coil voltage applied starting from 25° C DC Contactor temperature. Duty Cycle=On Time/(On Time + Off Time). ²Voltagess listed are minimum required at 25° C coil temperature. Minimum voltage requirements will increase with coil temperature. ³Amps at Max Duty Cycle. ⁴Risetime ≥ 3 milliseconds to 80% of peak inrush with linear decay to run (carry) current in ≤1 seconds.

Enter Complete Part Number Below –
Ordering Information • Some configurations are not available. Contact your Trombetta sales rep before ordering.

Family	Coil Connection Configuration	High Current Stud	Coil Voltage	Bracket Type	Bracket Location	Duty Cycle	Contact Material	Sealing
<input checked="" type="checkbox"/>	<input checked="" type="checkbox"/>	<input checked="" type="checkbox"/>	<input checked="" type="checkbox"/> - <input checked="" type="checkbox"/>	<input checked="" type="checkbox"/>	<input checked="" type="checkbox"/>	<input checked="" type="checkbox"/>	<input checked="" type="checkbox"/>	<input checked="" type="checkbox"/>
6- Power Seal	3- Grounded 10/32 5- Grounded (1) 10-32 Stud + Spade 8- Non-Grounded (2) 10/32 9- Non Grounded (2) 10-32 Studs+Spades	4- Standard Power Seal	12- 12 Volt 15- 15 Volt 24- 24 Volt 36- 36 Volt 48- 48 Volt	1- L Bracket, Curved 2- Flat Bracket 3- Curve Bracket 4- 90 Degree Bracket 5- L Bracket, Flat 6- L Bracket Curved Narrow 7- L Bracket Flat, Long	1- Standard	0- 100% Continuous 2- 25%	1- Intermittent Duty & 12V Continuous Duty - Copper, 24, 36& 48V Continuous Duty, Silver Alloy Stationary Contacts with Silver Alloy Plated Moveable Contacts.	2- Sealed Design



L Flat Bracket

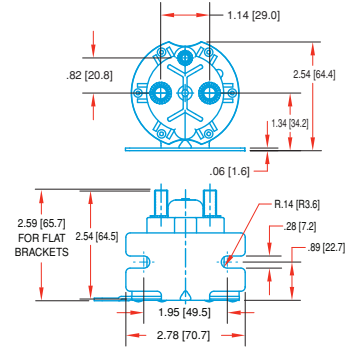

90° Bracket

Refer to L Bracket configuration for additional dimensions.

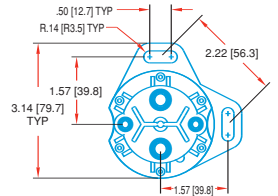

Flat Bracket

Refer to L Bracket configuration for additional dimensions.

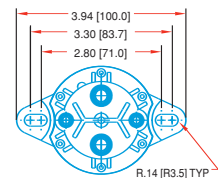

L Bracket

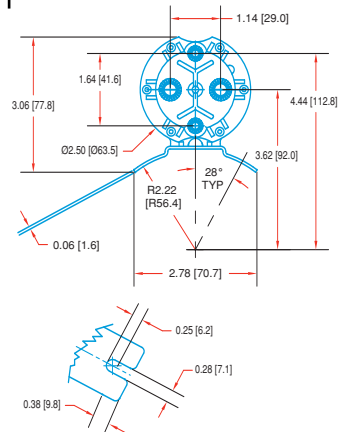
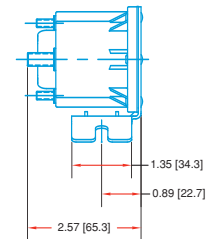

SL1002Rev1

Other brackets are available. Please see our web site (www.trombetta.com) for additional drawings.